

Envolee Double Biscuit Pendant Light

1:Assembly of lamp body

2:Fix the hanging board to the ceiling

3:Connect the lamp wires to the reserved wires

4:Fix the ceiling tray and hanging board from the side

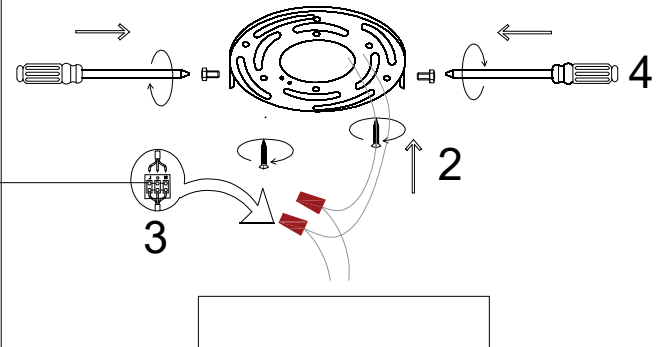
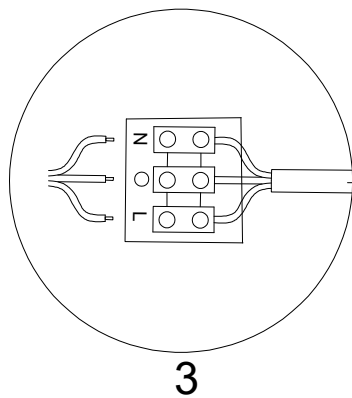

Enlarged Detail

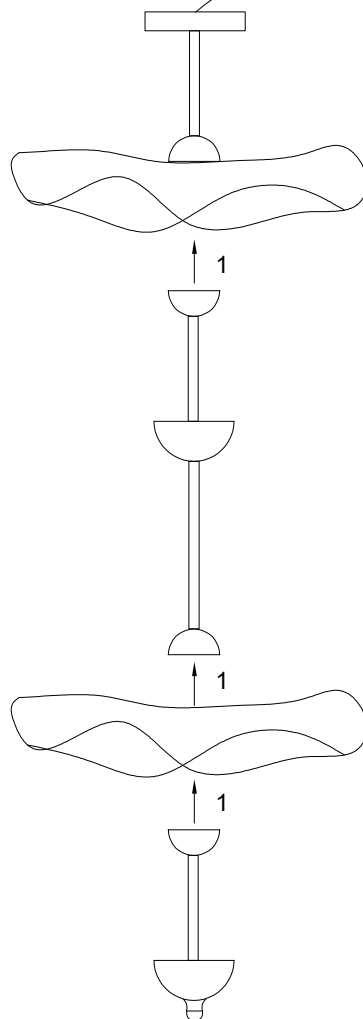

Envolee Double Biscuit Pendant Light

1:Assembly of lamp body

2:Fix the hanging board to the ceiling

3:Connect the lamp wires to the reserved wires

4:Fix the ceiling tray and hanging board from the side

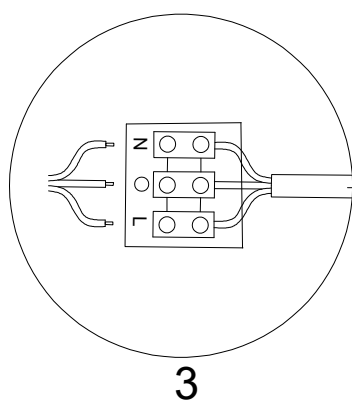

3

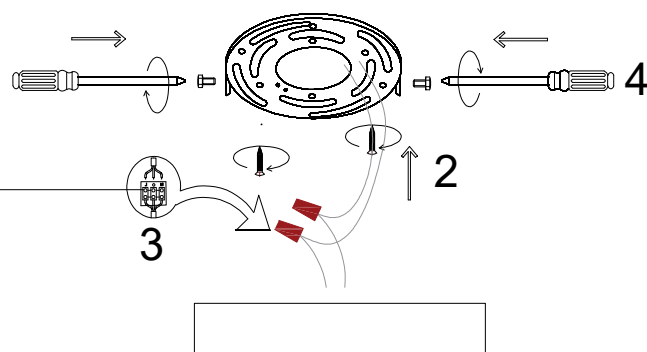

4

2

3

Enlarged Detail

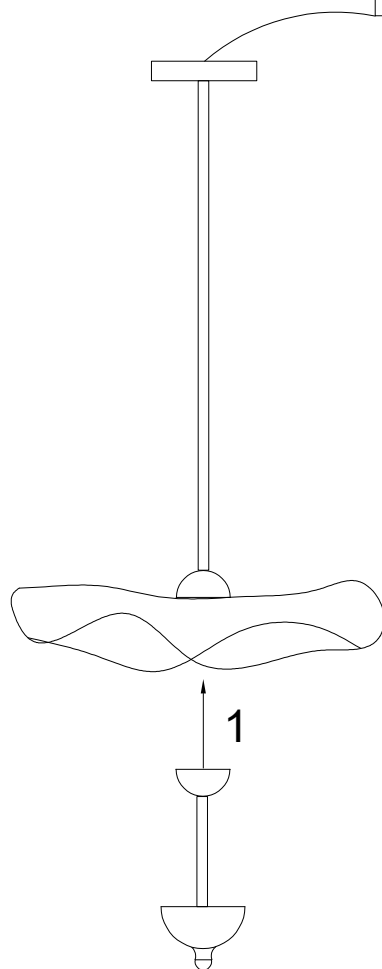

1

Envolee Double Biscuit Pendant Light

1:Assembly of lamp body

2:Fix the hanging board to the ceiling

3:Connect the lamp wires to the reserved wires

4:Fix the ceiling tray and hanging board from the side

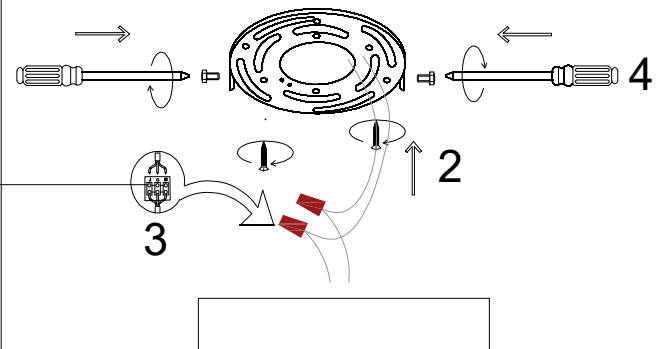
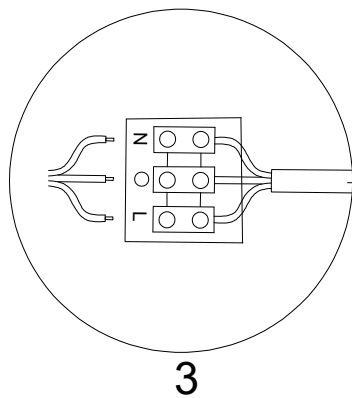

Enlarged Detail

